

REVISIONS			
REV	DESCRIPTION	DATE	APPROVED
A	UPDATED DRAWING AND TITLE BLOCK	3/7/05	LW

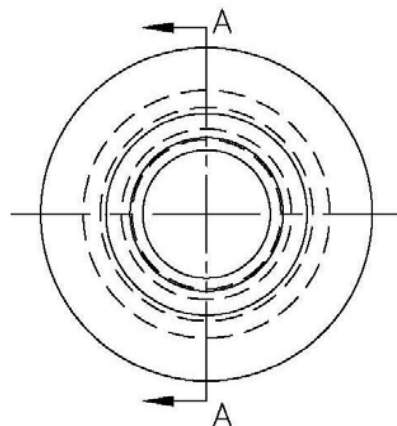
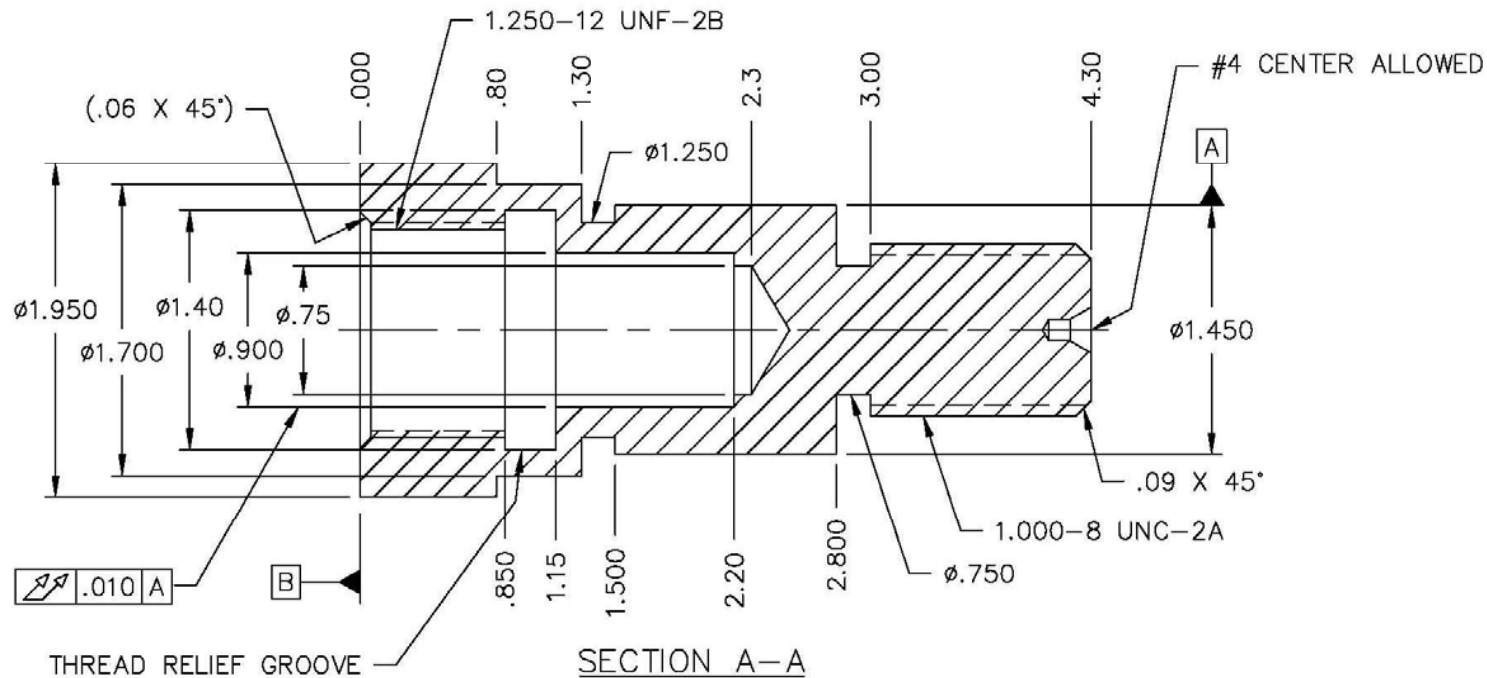

**NOTES:**

1. FINISH ALL OVER 125 MICROINCHES MAX
2. BREAK ALL SHARP EDGES .015" MAX.
3. EXTERNAL SURFACES:  $\square \square \square \phi .005 \square \square$
4. ALL EXTERNAL NON-THREADED DIAMETERS:  $\square \square \square .010 \square \square \square$

<p>UNLESS OTHERWISE SPECIFIED DIMENSIONS ARE IN INCHES INTERPRET DIMENSIONS AND TOLERANCES PER ASME Y14.5M-1994</p> <p>TOLERANCES  .X ± .032 .XXX ± .005  .XX ± .015 ANGLES ± 1 DEG.  FRACTIONS ± 1/64</p>	MACHINING SKILLS LEVEL I		
	Job Duty 2.4 Turning Operation, Chucking		
	DESIGNER	DK	11/8/01
	DWG CHK		
			MATERIAL COLD ROLL STEEL OR MILD STEEL
DWG APPD			
SCALE	FULL	DWG.#98601 I	SHEET 1 OF 1

DO NOT SCALE DRAWING

**NIMS PROCEDURAL REQUIREMENTS**

1. SUBMIT THIS PRINT AND WORKPIECE ALONG WITH THE PERFORMANCE AFFIDAVIT FOR EVALUATION